

1. PRODUCT NAME

PACC Wrap® Corner Flashing Kits
Patent Pending

2. MANUFACTURER

PACC Systems, LLC
3790 Sagebrush Lane
Cincinnati, OH 45251
Phone: 513-245-0444
Fax : 513-385-3790
Tech Support: 513-404-0977
E-mail: info@paccsystems.com
Web: www.paccsystems.com

3. DESCRIPTION

PACC Wrap® Corner Flashing Kits (CFK's) are designed to be used with PACC Wrap® Flexible Pan Flashing and other adhesive backed membrane flashings to protect and seal the corner area at the intersection of the sill/threshold, jamb, and sheathing members.

4. LIMITATIONS

None when used for the design purpose.

5. MATERIALS AND COMPOSITION

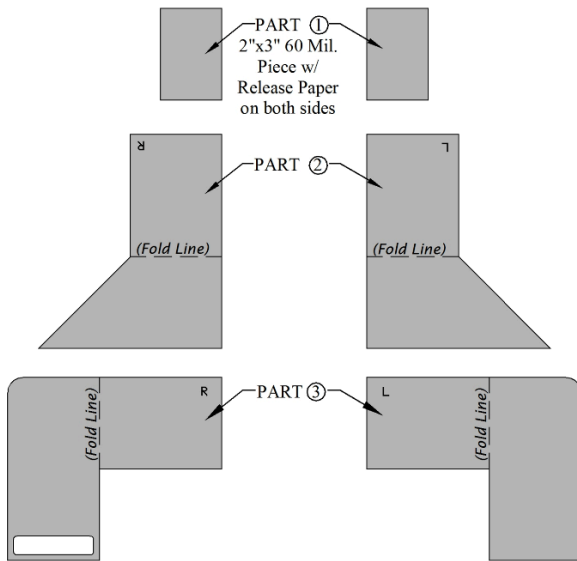

A PACC Wrap® Corner Flashing Kit contains two types of waterproofing pieces.

The first type is a 60mil modified and reinforced asphalt that is protected on both adhesive sides with disposable release paper. This material is furnished in

2-inch by 3-inch pieces. It is the waterproofing protection at the corner intersection of the sill/threshold, jamb, and sheathing members. There are two pieces per kit. They are Part 1 in the instructions.

The second type is modified asphalt that is laminated to a 2.75mil polyethylene film and protected with a disposable release sheet. This material is furnished in four pieces that make up left and right sets. Each set covers a 60mil piece that has been shaped and adhered onto the corner intersection of the sill/threshold, jamb, and sheathing members. The function of each set is to permanently hold the 60mil piece against the surfaces and protect it from damage during the window and door installation. There are two sets per kit. They are Parts 2 and 3, of a left and right set, in these instructions.

6. PHYSICAL PROPERTIES

Thickness:	
Primary waterproofing piece	60mils
Protective cover set	25 mils/pc.
Water Vapor Transmission	
ASTM-E-96 B US Perms	<.02
Peel Adhesion ASTM D 1000	>5.0 lbs.in.width
Elongation-Ultimate Failure of Rubberized Asphalt	> 500%
Low Temperature Pliability	
ASTM D 146 Modified no cracking at -15° F.	

7. CHEMICAL RESISTANCE

Asphalt products are not compatible in direct contact with: uncured urethane; cured or uncured silicone.

8. TECHNICAL DATA

PACC Systems, LLC provides design data and installation instructions to architects, engineers, specifiers, and contractors.

9. INSTALLATION

NOTES: Install adhesive backed asphalt flashing onto the rough opening sill/threshold and jambs and then install a CFK over that flashing and the sill/threshold, jamb, and sheathing corners. The illustrations depict a pan flashing on a window sill. The application onto the corners of a window sill or door threshold that is flashed with straight adhesive backed asphalt flashing is the same.

Storage: Protect the material from heat, crushing, moisture, mud and construction dirt. Keep the product in the package until it will be used. For best results, the material should be stored between 50 to 75 degrees F prior to application.

Preparation: Prepare the surfaces where the PACC Wrap® CFK components will be attached so that, they are smooth relative to the construction surface, clean and dry.

Product Attachment: Apply a liquid adhesive, at a rate of 250-300 sq. ft. per gallon, to the surfaces that will receive the CFK. Use a liquid adhesive that is compatible with the substrate i.e. solvent based Polyguard 650LT, (in California, Polyguard California Sealant) for substrates that are compatible with solvent based material and water based Polyguard Shur-Tac for substrates that are not compatible with solvent based materials. After the liquid adhesive dries, test for adhesion with the asphalt membrane in the following manner. If the CFK can be separated from the substrate without deforming the flashing: reapply another coat of liquid adhesive; allow more time for the liquid adhesive to dry or; do both. Dens Glass will require a minimum of two coats.

INSTALLING a PACC Wrap® Corner Flashing Kit

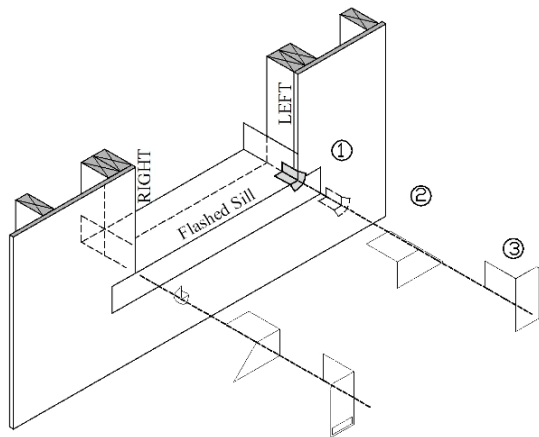

1. Remove the protective release paper and sheet from Part 1 then shape and adhere it onto the left corner (facing out of the building) so that: a 1-inch by 1 ½-inch part will cover the sill/threshold member in the rough opening corner; a 1-inch by 1 ½-inch part will cover the jamb member in the rough opening corner and; the balance of the piece will cover the exterior face of the sheathing.
2. Remove the protective release sheet from Part 2, “L” stamped on the face of the part, then shape and adhere it over the top of Part 1 and onto the rough opening sill/threshold flashing with the edge of the rectangular section against the left jamb, with the point where the edge of the triangular extension

and the edge of the rectangular body meet positioned over the point where the sill/threshold, jamb and wall intersect, and with the triangular shape on the face of the wall.

3. Remove the protective release sheet from Part 3, “L” stamped on the face of the part, then shape and adhere it over the top of Part 1 and onto the side of the rough opening jamb flashing with the edge of the rectangular section against the flashed sill/threshold, with the point where the edge of the rectangular extension and the edge of the rectangular body meet positioned over the point where the sill/threshold, jamb, and wall intersect, and with the remaining rectangular shape on the face of the wall.
4. Apply pressure to the adhered surfaces with a hard surfaced rubber roller.
5. Repeat 1) through 4) for the right side substituting the word right for left and the letter “R” for “L” in the instructions.

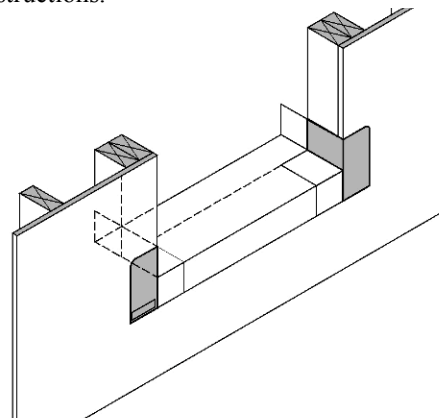

Safety: Material Safety Data Sheets are available upon by phone, e-mail, or on the web.

10. AVAILABILITY AND COST

Kits are packaged 50 per box, enough for 50 rough openings.

Information about a distributor near you is available by phone or e-mail.

11. GUARANTEE

PACC Wrap® Corner Flashing Kits will meet published specifications at the time of delivery.

12. TECHNICAL SERVICES

PACC Systems, LLC offers specialist advice to aid the architect, engineer, and contractor with the construction process.

© PACC Systems I.P. LLC 2007