

MASONRY LINTEL FLASHING INFORMATION

PACC® System Products needed to proceed:
Drip Edge Flashing with Slide 'N Seal Ends™ (DEF).
PACC® Flash 'N Weep®, concealed flashing (FNW).
Other products needed to proceed:
Either Polyguard 650LT Liquid Adhesive or Polyguard Shur-Tac Liquid Adhesive, refer to Product Attachment Read the product installation instructions before proceeding.

Preparation:

Prepare the support ledge where the DEF will be placed so that it will have a positive pitch away from the backing wall and will be free from irregularities that would interfere with a flat interface between materials.
Prepare the surfaces where the FNW will be placed so that they will be clean, dry, and free from irregularities that would interfere with a flat interface with the flashing side of the FNW and with the DEF.

Product Attachment:

When joining DEF sections together, wipe the underside of the joining section end where it will interface with the seal tape. Use a clean rag with a 15% solution of Isopropyl Alcohol and water. (A 4 oz. spray bottle, with the 15% solution, is included with every bundle of 25 Drip Edge Flashing sections.)
Except for the surface of the DEF, apply a liquid adhesive, at a rate of 250-300 sq. ft. per gallon, to the prepared surfaces. Use a liquid adhesive that is compatible with the substrate i.e. solvent based Polyguard 650LT for substrates that are compatible with solvent based material and water based Polyguard Shur-Tac for substrates that are not compatible with solvent based materials. After the liquid adhesive dries, test for adhesion to the substrates. If the FNW can be separated from the substrate without deforming, then reapply another coat of liquid adhesive. Dens Glass will require a minimum of two coats.

Where an air barrier wrap or building paper is present, trim it accurately along where the top edge and sides of the PACC® Flash 'N Weep® will be and remove the cut section from the area of adhesion for the flashing side of the FNW.

End Dams located in the masonry head joints at or beyond the lintel ends.

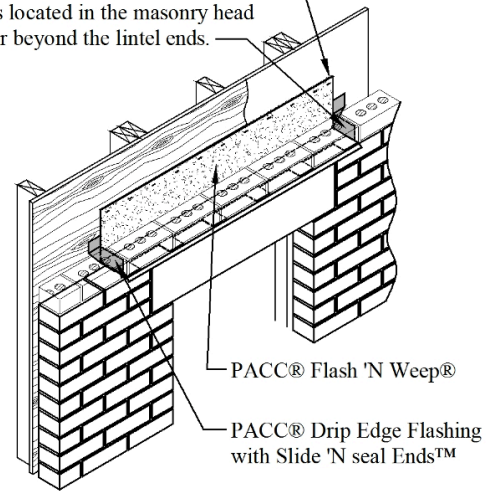

1. Where an air barrier wrap or building paper is present, trim it accurately along where the top edge and sides of the PACC® Flash 'N Weep® will be and remove the cut section from the area of adhesion for the flashing side of the FNW.
2. Install the DEF so it will cover the masonry lintel with each end aligned to where the closest head joint will be at or beyond the end of the masonry lintel.
3. Fold the release paper on the back left side of the FNW to expose 2-inches of the flashing membrane.

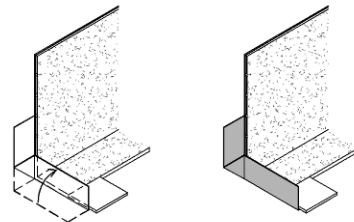

4. Remove the 1/2-inch wide section of release sheet from an End Dam and align the remaining release sheet edge with the left edge of the FNW. Position the forward edge of the End Dam 5/8-inch from where the face of the masonry will be located and then join the aligned and positioned End Dam onto the exposed flashing on the back of the FNW.
End Dams are packaged with the FNW sections. They have a protective release paper on the back side and a protective release sheet on the front side. The front release sheet is slit to make two sections: a 1/2-inch section and a 1-1/2-inch section. Remove the release paper and release sheet sections as instructed.
5. Bend the FNW to form a horizontal and vertical leg.
6. Fold the End Dam upward along the side of the cell extension and pinch it together at the back corner.

7. Remove the release paper from the back of the End Dam.
8. Rotate the pinched End Dam section to the left of the FNW and positioned to be parallel with the backing wall.
9. Install the FNW with the rear corner of the End Dam positioned into the left end intersection of the DEF and the backing wall.

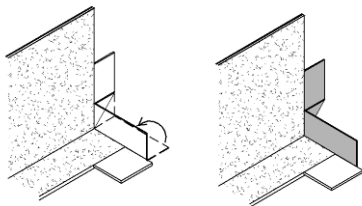

10. End the FNW installation as follows:
When the lintel is 4-feet or less cut the FNW along the right end to meet the length of the lintel. Attach an End Dam piece along the right end of the FNW, form it into an End Dam, and rotate it to the right side of the FNW.
When the lintel length is greater than 4-feet, cut the ending FNW section along the right side of a cell extension and then cut the remaining piece to the length needed to cover to the end of the Drip Edge Flashing. Attach an End Dam piece along the right side of the cell extension, form it into an End Dam, and rotate it to the right side of the FNW.
11. Install fasteners, appropriate for the substrate, within 1-inch and along the top edge of the FNW and within 1-inch of each side of and along the flashing joint at 4-inch spacing. When the substrate is foam sheathing with a plastic film on the face, fasteners along the top edge are not required.
12. Embed the End Dams in head joints of the masonry.

PACC Systems, LLC
3790 Sagebrush Lane
Cincinnati, OH 45251
Phone: 513-245-0444
Fax: 513-385-3790
Tech Support: 513-404-0977
E-mail: info@paccsystems.com
Web: www.paccsystems.com