

## MASONRY SILL FLASHING INFORMATION

PACC® System Products needed to proceed:  
Drip Edge Flashing with Slide 'N Seal Ends™ (DEF)  
PACC® Flash 'N Weep®, concealed flashing ( FNW).

Other products needed to proceed:

Either Polyguard 650LT Liquid Adhesive or Polyguard Shur-Tac Liquid Adhesive, refer to Product Attachment section.

Read the product installation instructions before proceeding.

### NOTES:

The word threshold can be substituted for sill when applicable.

The best practice for constructing a durable rowlock masonry sill that is through wall flashed, is to construct the height of the assembly on the through wall flashing with at least one stretcher course under the rowlock. An assembly constructed this way vs. constructed with the rowlock directly on the TWF has more bonded mass and is less likely to crack when the assembly is stressed.

The width of a masonry sill FNW concealed through wall flashing, should equal at least the width of the sill opening with the sides of the FNW in plane or extending beyond the sides of the opening. When constructing the opening for the sill assembly, plan for the location of the FNW end dams to be embedded in head joints at the ends of the DEF.

Where the rough opening sill has been flashed and has a vertical leg of flashing covering the backing wall, adhere the FNW onto the face of that flashing with the top edge no closer than ½-inch to the sill.

Where rough opening sill flashing is not present at the sill to backing wall intersection, locate the top edge of the FNW within ½-inch of that intersection.

Where the height of the FNW will not fit in a space allowed for the concealed flashing, cut the vertical leg of the FNW to fit.

### Preparation:

Prepare the support ledge where the DEF will be placed so that it will have a positive pitch away from the backing wall and will be free from irregularities that would interfere with a flat interface between materials.

Prepare the surfaces where the FNW will be placed so that they will be clean, dry, and free from irregularities that would interfere with a flat interface with the flashing side of the FNW and with the DEF.

### Product Attachment:

When joining DEF sections together, wipe the underside of the joining section end where it will interface with the seal tape. Use a clean rag with a 15% solution of

Isopropyl Alcohol and water. (A 4 oz. spray bottle, with the 15% solution, is included with every bundle of 25 Drip Edge Flashing sections.)

Except for the surface of the DEF, apply a liquid adhesive, at a rate of 250-300 sq. ft. per gallon, to the prepared surfaces. Use a liquid adhesive that is compatible with the substrate i.e. solvent based Polyguard 650LT for substrates that are compatible with solvent based material and water based Polyguard Shur-Tac for substrates that are not compatible with solvent based materials. After the liquid adhesive dries, test for adhesion to the substrates. If the FNW can be separated from the substrate without deforming, then reapply another coat of liquid adhesive. Dens Glass will require a minimum of two coats.

Where an air barrier wrap or building paper is present, trim it accurately along where the top edge and sides of the PACC® Flash 'N Weep® will be and remove the cut section from the area of adhesion for the flashing side of the FNW.

End Dams located in the masonry head joints at or beyond the sill ends.

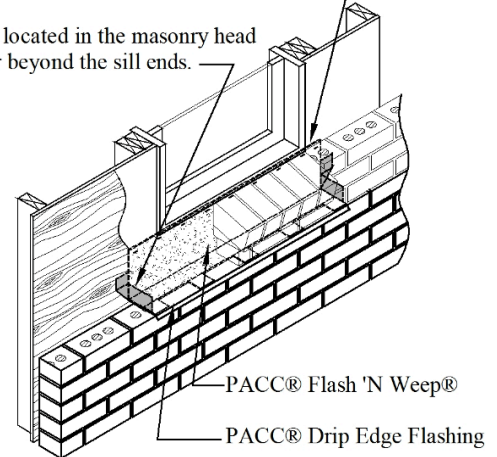

1. Install the DEF so it will cover the masonry support ledge for the sill assembly with each end aligned to where the closest head joint will be at or beyond the end of the sill opening.

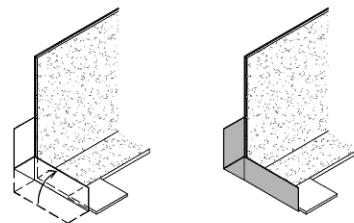

2. Fold the release paper on the back left side of the FNW to expose 2-inches of the flashing membrane.
3. Remove the ½-inch wide section of release sheet from an End Dam and align the remaining release

sheet edge with the left edge of the FNW. Position the forward edge of the End Dam 5/8-inch from where the face of the masonry will be located and then join the aligned and positioned End Dam onto the exposed flashing on the back of the FNW.

End Dams are packaged with the FNW sections. They have a protective release paper on the back side and a protective release sheet on the front side. The front release sheet is slit to make two sections: a 1/2-inch section and a 1-1/2-inch section. Remove the release paper and release sheet sections as instructed.

4. Bend the FNW to form a horizontal and vertical leg.
5. Fold the End Dam upward along the side of the cell extension and pinch it together at the back corner.
6. Remove the release paper from the back of the End Dam.
7. Rotate the pinched End Dam section to the left of the FNW and positioned to be parallel with the backing wall.
8. Install the FNW with the rear corner of the End Dam positioned into the left end intersection of the DEF and the backing wall.

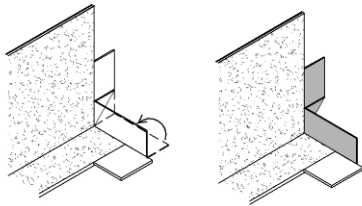

9. End the FNW installation as follows:  
When the sill is 4-feet or less cut the FNW along the right end to meet the length of the sill. Attach an End Dam piece along the right end of the FNW, form it into an End Dam, and rotate it to the right side of the FNW.  
When the sill length is greater than 4-feet, cut the ending FNW section along the right side of a cell extension and then cut the remaining piece to the length needed to cover to the end of the DEF. Attach an End Dam piece along the right side of the cell extension, form it into an End Dam, and rotate it to the right side of the FNW.
10. Install fasteners, appropriate for the substrate, within 1-inch and along the top edge of the FNW and within 1-inch of each side of and along the flashing joint at 4-inch spacing. When the substrate is foam sheathing with a plastic film on the face, fasteners along the top edge are not required.
11. Embed the End Dams in head joints of the masonry and construct the masonry sill assembly.

PACC Systems, LLC  
3790 Sagebrush Lane  
Cincinnati, OH 45251  
Phone: 513-245-0444  
Fax: 513-385-3790  
Tech Support: 513-404-0977  
E-mail: [info@paccsystems.com](mailto:info@paccsystems.com)  
Web: [www.paccsystems.com](http://www.paccsystems.com)

© PACC Systems I.P. LLC 2007